**FAG****4216-B-TVH**

Deep groove ball bearing

Deep groove ball bearing 42...-B-TVH, double row, plastic cage

Materiálové číslo Schaeffler: 0190585350000

Technické informace

Vaše aktuální varianta produktu

Design variant	B	Bearing without filling slot
Cage	TVH	Solid cage made of glass-fiber reinforced polyamid PA66
Radial internal clearance	CN (Group N)	Normal internal clearance

Main Dimensions & Performance Data

d	80 mm	Bore diameter
D	140 mm	Outside diameter
B	33 mm	Width
C_r	81.000 N	Basic dynamic load rating, radial
C_{0r}	90.000 N	Basic static load rating, radial
C_{ur}	4.500 N	Fatigue load limit, radial
n_G	3.800 1/min	Limiting speed
n_{gr}	4.200 1/min	Reference speed
$\approx m$	1,98 kg	Hmotnost

Mounting dimensions

$d_{a \min}$	91 mm	Minimum diameter shaft shoulder
$D_{a \max}$	129 mm	Maximum diameter of housing shoulder
$r_{a \max}$	2 mm	Maximum fillet radius

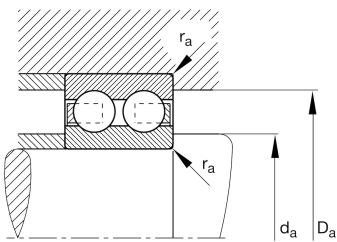
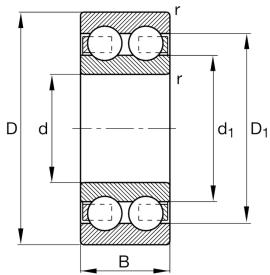



Dimensions

r_{\min}	2 mm	Minimum chamfer dimension
D_1	124 mm	Shoulder diameter outer ring
d_1	105,2 mm	Shoulder diameter inner ring





Temperature range

T_{\min}	-20 °C	Operating temperature min.
T_{\max}	120 °C	Operating temperature max.

Calculation factors

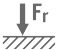
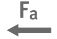
f_0	15,7	Calculation factor
-------	------	--------------------

Vlastnosti

-  F_r Radiální zatížení
-  F_a Axiální zatížení v jednom směru
-  F_a Axiální zatížení ve dvou směrech
-  Mazání (plastickým mazivem)
-  Neutěsněné