



Bushings for Locating Pins (Flanged Configurable)

Standard

Standard Type



RoHS 10

Type			Material	Surface Treatment	Hardness
p6	m6	h7			
JBHF	JBHF	JBHFH	O1 Tool Steel or Equivalent	—	56~60 HRC min.
JBHFMP	JBHFMP	JBHFMPH		Black Oxide	56~60 HRC min.
JBHF	JBHF	JBHFH		Electroless Nickel Plating	56~60 HRC min.
JBHFSP	JBHFSP	JBHFSPH	304 Stainless Steel	—	—
JBHF	JBHF	JBHFH	440C or 420 Stainless Steel	—	50~55 HRC min.

Ⓢ For hole machining, please note that inner diameter shrinkage of p6 Type is larger than that of m6 Type. (See "Variance of Inner Diameter after Press-fitting Bushings for Locating Pins" on P.1680.)

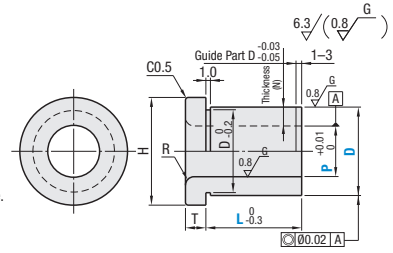

Type	D	Part Number			P 0.01 mm Increment	L 0.1 mm Increment	Thickness (N)	R	H	T			
		D Tolerance											
		p6	m6	h7									
(p6)	5	+0.020	+0.012	0	2.20-2.50	3.0-3.5	1.25-1.40	0.8	9	2.5			
	6	+0.012	+0.004	-0.012									
	7	+0.024	+0.015	0	2.20-3.50	3.0-6.0	1.75-2.50	0.8	11	3			
	8												
	9				+0.015	+0.006	-0.015						
	10	+0.029	+0.018	0	3.00-4.50	3.0-10.0	1.75-2.50	1.0	12	13.5			
	11												
	12				+0.018	+0.007	-0.018	4.00-6.50	3.0-15.0	1.75-3.00	1.0	14	15
	13												
	14	(m6)	+0.029	+0.018	0	6.00-8.50	3.0-15.0	1.75-3.00	2.0	16	17		
15													
16	8.00-10.50					5.0-35.0	2.25-3.50	2.0	18	19			
17													
18	10.00-12.50					5.0-35.0	2.75-4.00	2.0	20	21			
19													
20	12.00-13.50					5.0-35.0	2.75-4.00	2.0	22	24			
21													
22	+0.035					+0.021	0	12.00-13.50	5.0-35.0	4.25-5.00	2.0	26	26
23													
24	+0.022	+0.008	-0.021	13.00-15.50	5.0-35.0	4.75-6.00	2.0	28	30				
25													
26	15.00-16.50	5.0-35.0	4.75-5.50	2.0	30	30							
27													
28	16.00-16.50	5.0-35.0	4.75-5.50	2.0	31	33							
29													
30	16.00-20.50	5.0-50.0	4.75-7.00	2.0	35	35							
31													
32	+0.042	+0.025	0	16.00-20.50	5.0-50.0	4.75-7.00	3.0	36	36				
33													
34	+0.026	+0.009	-0.025	20.00-25.00	5.0-50.0	5.00-7.50	3.0	38	38				
35													

Ⓢ L+T≤Px2.5 when P≤3.59 L+T≤Px3.0 when P≥3.60



Part Number Example

Part Number - P - L
JBHFM25 - P14.00 - L20.0



Part Number Alterations

Part Number - P - L - (RC, TC)
JBHFM12 - P8.00 - L12.0 - RC

Alterations	Code	Spec.
Inner Diameter Radius R 	RC	Machines Radius R on both sides. Thickness 1.5 mm or more Size of R will be the same as R on shoulder side with D dimension 10 or more. Ordering Code: RC
Shoulder Thickness 	TC	1 mm Increment Ordering Code: TC4 3≤TC≤T Ⓢ O.A.L. becomes short as much as T-TC. Ⓢ Applicable when D≥12.